

ARPU

BY STUDIO HAUCH

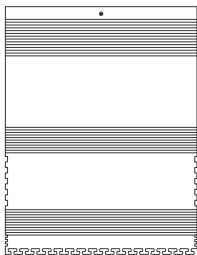

What's inside?



The top



The bottom

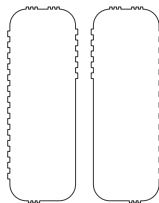

The sides

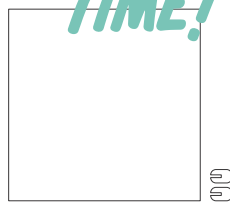

The base panel
with holders

*PUZZLE
TIME!*

X3

The legs
with holder

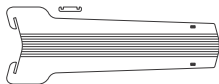

The lock



An alternative lock

1. Snap top, bottom and sides together.

The side that faces up right now, will be the inside of Arpu later.

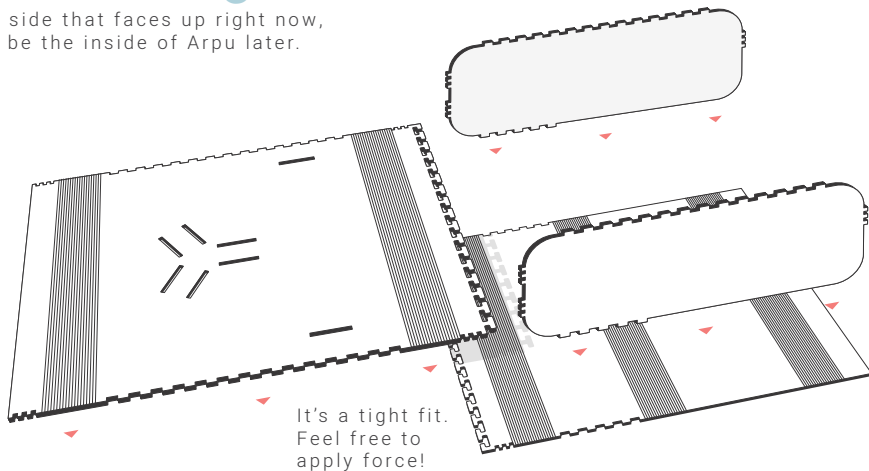

! It might be a good idea to put something protective underneath. How about a blanket?

2. Roll and snap
all sawteeth
together.

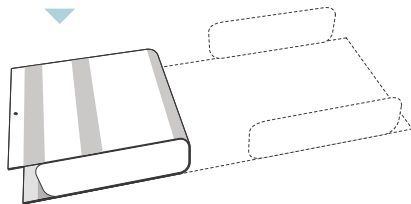
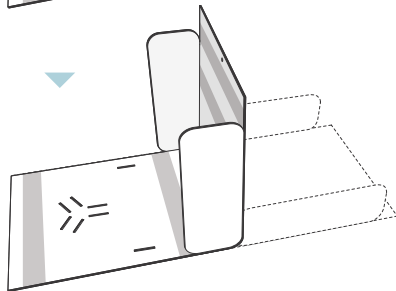
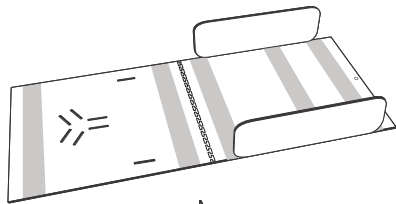

3. Fold the three legs

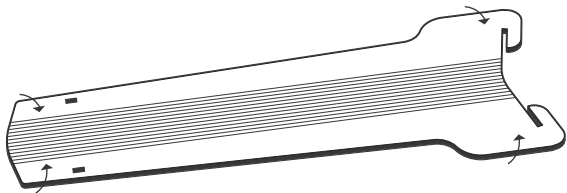

*WILL IT
BEND?*

Don't be scared, they won't break. Just start by gently folding them. When you feel they are ready to hold, attach the holder.

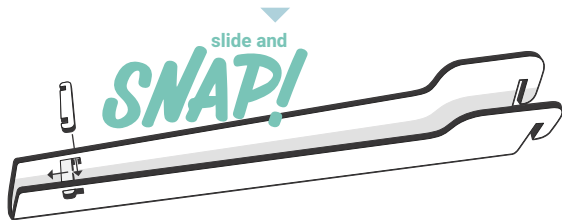

4. Attach the legs to the body.

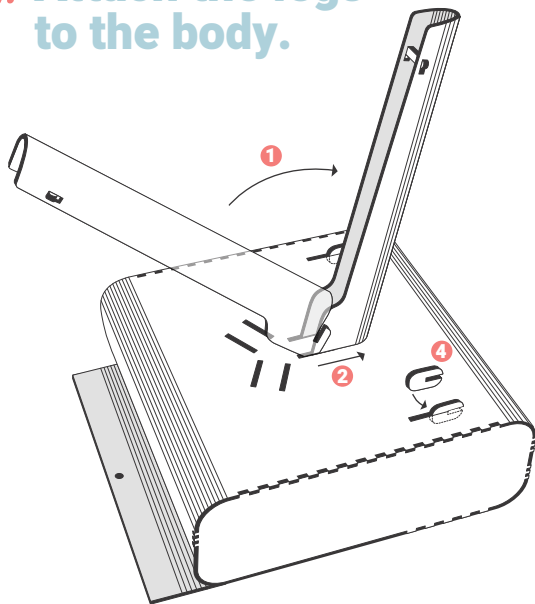

- 1 Insert the leg in the slots.
- 2 Make sure the top of the leg is parallel to the body, then slide the leg outward.
- 3 Repeat three times.
- 4 Insert the two holders for the base panel.



5. Insert the base panel
and attach the lock.

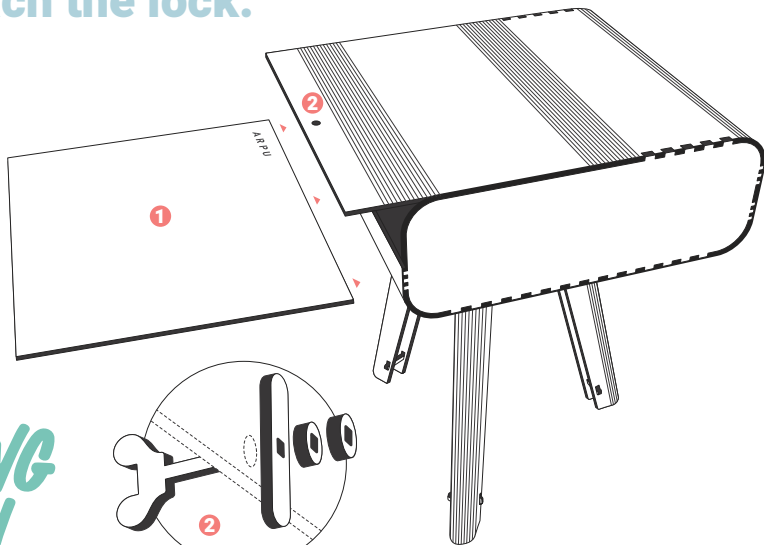

*THE
FINISHING
TOUCH*

**NICE!
YOU'RE
DONE!**

Now pour that drink or switch on that
nightlight and enjoy the moment!



* That is fiery passion! Every piece is precisely cut by a laserbeam, leaving behind the heavenly smell of burnt wood. Don't like it? No problem, it will just fade over time.

* * Bamboo grows insanely fast, whilst keeping the qualities of hardwood, making it a highly durable and ecological alternative to other materials.

* * * You can actually assemble this table with your bare hands. You won't need any kind of tool, metal part or glue.